

TWO-PLY JUMBO TEX®

WEATHER-RESISTIVE BARRIER

PREMIER

Part of a Complete Moisture Control System

Two-Ply Jumbo Tex is a member of the Jumbo Tex family – a product line that has set the industry standard for effectiveness and durability as a weather-resistive barrier behind all major exterior wall claddings. It has been chosen by builders and architects to protect over *five million* homes and commercial buildings from the problems caused by water intrusion and excessive moisture.

“Provides the ideal balance between water protection and vapor permeability, to keep walls dry and homes comfortable...”

Two-Ply Jumbo Tex is engineered for production and custom residential construction applications that require a tough water and moisture barrier that offers outstanding water and moisture protection. It delivers over *ten times* the water resistance of regular Grade “D” building paper, while having the durability to endure rugged jobsite conditions. The product is part of a complete Moisture Control System for walls

engineered by the Fortifiber Building Systems Group®, which helps manage and eliminate moisture-related problems – including water-related structural failures, mold and mildew.

Two-Ply Jumbo Tex provides the ideal balance between water protection and vapor permeability, to keep walls dry and homes comfortable. The product also reduces air infiltration in exterior walls, contributing to energy savings.

Two-Ply Jumbo Tex is comprised of two layers of asphalt-saturated building paper, which is considered by many building science experts to provide the ideal drainage plane behind exterior claddings, and to increase the drying potential of the wall system when wet. Dual layers result in better sealing around attachment fasteners and better building envelope integration. Unlike some housewraps, it will retain its weather-resistive properties when exposed to either job site surfactants or wood extracts and tannin derivatives from wood siding.

Unique Weather-Resistive Properties

The product’s pliability and 40 inch wide roll size make it easier to install and store on the jobsite than other weather-resistive building materials. It is also a very cost-effective solution, while providing solid protection against water intrusion and moisture problems. When the code requires two layers of Grade “D” building paper, Two-Ply Jumbo Tex does the job in one pass, saving costly labor dollars. In fact, it is possible to pay up to three times more for other weather-resistive barriers that cannot surpass its reliable performance behind stucco, fiber cement siding, brick, vinyl and wood siding.

Decades of Proven Performance

Two-Ply Jumbo Tex is a product manufactured by the Fortifiber Building Systems Group. With more than a seventy year history of proven performance, technical expertise and practical know-how, the company has become a trusted partner to builders, architects and code officials.

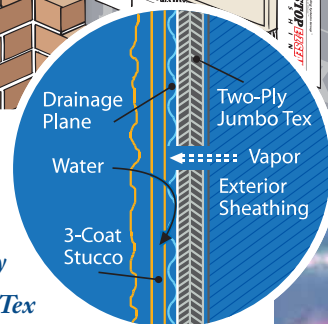
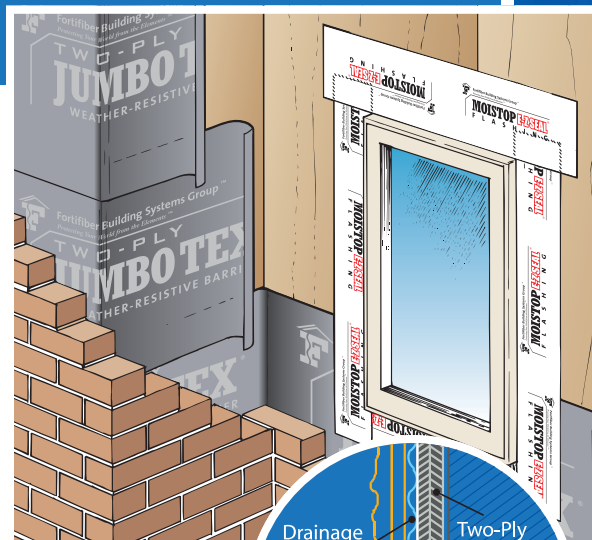

Two-Ply
Jumbo Tex

protects against water intrusion from the outside, while allowing moisture to escape from the inside.

- SOLID PROTECTION AGAINST MOISTURE PROBLEMS
- EXCEPTIONAL WATER RESISTANCE
- SOLID PRICE-PERFORMANCE
- IDEAL BALANCE BETWEEN WATER RESISTANCE AND PERMEABILITY
- FOR STUCCO, FIBER CEMENT SIDING, BRICK, VINYL AND WOOD SIDING
- LABOR SAVINGS FOR TWO-PLY CODE REQUIREMENTS



TWO-PLY JUMBO TEX

Product Description: Two-Ply Jumbo Tex is a premier grade weather-resistive barrier designed for use behind a variety of exterior wall claddings. It provides excellent protection from internal wall damage due to moisture leakage and condensation.

Composition: Two-Ply Jumbo Tex is an asphalt-saturated kraft Grade “D” breather type sheathing paper.

Size & Weight: Two-Ply Jumbo Tex is available in 40" x 162 sq. ft. and 40" x 250 sq. ft. rolls. Product weight is approximately 7.2 lbs/100 sq. ft.

Applicable Standards: Exceeds Federal Specification UU-B-790a, Type 1, Grade “D”, Style 2.

Complies with the Uniform Building Code Standard 14-1.

Complies as an alternative to the water-resistive barrier specified in Section 1404.2 of the 2006 International Building Code®.

Complies as an alternative to the weather-resistant sheathing papers specified in Section R703.2 of the 2006 International Residential Code®.

ICC ESR-1027, BOCA Evaluation Report No. 21-46, SBCCI Evaluation Report No. 2103 and CCMC Evaluation Listing No. 13142-L.

American Society for Testing & Materials (ASTM):

- *ASTM D-779 - Standard Test Method for Water Resistance of Paper, Paperboard and Other Sheet Materials by the Dry Indicator Test Method*
- *ASTM D-828 - Tensile Properties of Paper and Paperboard Using Constant-Rate-of-Elongation Apparatus*
- *ASTM E-96 - Water Vapor Transmission of Materials*

Physical Properties: Two-Ply Jumbo Tex is continually tested in accordance with ASTM procedures. The values shown in Table 1 are typical values obtained in these tests.

Limitations: Product should be covered as soon as possible. Inspect product to insure it is free of any protrusions or damage which may detract from the weather-resistive barrier integrity. Holes, tears or punctures should be sealed with Moistop® Sealant or Fortifiber Sheathing Tape. This product is not recommended for horizontal, below grade or roofing applications.

Installation: Two-Ply Jumbo Tex should be installed in accordance with the local applicable building code. The International Residential Code Section R703.2 and Uniform Building Code Standard 14-1, section 1402.1, state that weather-resistive barriers should be applied horizontally, with the upper layers overlapping the lower layer by a minimum of 2" (3" is recommended), and all vertical joints should be lapped a minimum of 6". To ensure the integrity of the weather-resistive barrier system, Fortifiber strongly recommends the use of a Two-Ply Jumbo Tex product or two layers of a single ply Jumbo Tex product when used with a three-coat stucco system. Do not tape horizontal or vertical seams.

Availability: The Fortifiber Building Systems Group's products are distributed nationwide. For product information and pricing, please call a Fortifiber distributor near you. If you need assistance locating a participating distributor, please call our Customer Service Department at 1-800-773-4777.

FortiShield Warranty: Two-Ply Jumbo Tex is expressly warranted for a period of ten (10) years from purchase that it will perform to Fortifiber's published specifications when installed according to Fortifiber's installation procedures and accepted industry standards in a standard weather-resistive barrier application. Installation must use one or more of the following Fortifiber brand flashing products (Moistop E-Z Seal®, FortiFlash®, FortiFlash® Butyl, Moistop neXT®, or Moistop PF®) with Moistop® Sealant in a properly designed and constructed wall system. In the event of a warranty claim, Fortifiber will pay the cost of materials and labor to correct problems found to be caused solely by the failure of Fortifiber's product as expressly warranted above.

THIS EXPRESS WARRANTY IS GIVEN IN LIEU OF AND EXCLUDES ALL OTHER EXPRESS OR IMPLIED WARRANTIES, INCLUDING BUT NOT LIMITED TO THE IMPLIED WARRANTIES OF MERCHANTABILITY AND FITNESS FOR A PARTICULAR PURPOSE. Fortifiber's sole obligations under this warranty are as set forth herein. In no event shall Fortifiber be liable for any lost revenue or profits, direct, indirect, special, incidental or consequential damages of any kind. If the installation or use of this product does not qualify for the FortiShield Warranty, Fortifiber's standard warranty will apply. See fortifiber.com/warranty.htm for details.

Table 1- Physical Properties

CHARACTERISTIC	TEST METHOD	RESULTS	INDUSTRY STANDARD
Water Vapor Transmission	ASTM E-96 (A)	95 grams 14 perms (MVT)	35 grams (min.) 5 perms (MVT)
Water Resistance	ASTM D-779	110 minutes	10 minutes per ply
Tensile Strength	ASTM D-828	MD - 144 lb. ^f /inch CD - 58 lb. ^f /inch	MD - 20 lb. ^f /inch CD - 20 lb. ^f /inch

SPECIFICATION SUMMARY: Provides secondary weather protection behind exterior cladding to prevent moisture penetration and condensation in exterior wall assemblies.

WEATHER-RESISTIVE BARRIER: Fortifiber/Two-Ply Jumbo Tex asphalt saturated kraft Grade “D” breather type sheathing paper.

REFERENCE SPECIFICATION: Federal Specification UU-B-790a, Type 1, Grade “D”, Style 2.



Fortifiber Building Systems Group®
Protecting Your World from the Elements®

Call 1-800-773-4777 or 1-775-333-6400 for sales and technical assistance. On the Internet visit www.fortifiber.com.

© 2011 Fortifiber Building Systems Group. Fortifiber®, FortiFlash®, FortiFlash® Butyl, FortiShield®, Jumbo Tex®, Moistop E-Z Seal®, Moistop neXT®, Moistop PF®, Moistop® Sealant and Protecting Your World from the Elements® are trademarks of Fortifiber Corporation. 02/11